



**The 1st Global Conference on Biomedical
Engineering (GCBME 2014)
&
The 9th Asian Pacific Conference on Medical and
Biological Engineering (APCMBE 2014)**

October 9-12, 2014

College of Medicine

National Cheng Kung University, Tainan, Taiwan

Sponsorship & Exhibitor Prospectus

Conference Organizing Committee
Department of Biomedical Engineering,
National Cheng Kung University
1 University Road, Tainan 701, Taiwan
apcmbe9@conf.ncku.edu.tw
<http://conf.ncku.edu.tw/apcmbe9/>

Invitation for Sponsorship

On behalf of the organizing committee, we would like to formally invite you to participate in the 1st Global Conference on Biomedical Engineering (GCBME 2014) & the 9th Asian Pacific Conference on Medical and Biological Engineering (APCMBE 2014). The conferences will be held at National Cheng Kung University (NCKU) in Tainan, Taiwan, Oct. 9-12, 2014. By merging these two important events, we provide the participants a wonderful platform to exchange their ideas, viewpoints and experience, and promote the up-to-date research development in the bioengineering field. We anticipate over 1500 academic and industrial engineers, hospital physicians, medical device manufacturers, and students from around the world to attend this year. Covering the highest quality research and development in biomechanics and bioengineering, it is thus a great opportunity to showcase your products and services in front of these potential customers. We are looking forward to seeing you in October 2014 at NCKU in Tainan, Tainan.

Please note that the **Sponsorship Request Form** must be filled out and returned before **July 31, 2014**. When space remains available, full payment will be charged immediately according to provided credit card information. Optional remittance is upon request. Failure to remit full payment **within two weeks** after notification will incur cancellation of reservation. An official confirmation letter will be sent to you once your registration is complete.

Sponsorship Levels

The three levels of sponsorship and the extra sponsorships will be allocated on a first-come, first-served basis.

| | Level Benefits | Platinum | Gold | Silver |
|---|---|---|---|----------------------|
| 1 | Rates | NT\$ 60,000 | NT\$ 33,000 | NT\$ 21,000 |
| 2 | Advertisement in the Program book | One A4-size color page and sponsor's name/logo listed on the front or back page | One A4-size B&W page | One A4-size B&W page |
| 3 | Advertisement on the conference website | Company name/logo on the conference website with a link to your website | Company name/logo on the conference website with a link to your website | |
| 4 | Flyer | One A4-size flyer of the sponsor included in the conference bag | | |

Extra Sponsorships

- Additional B&W page in the program book: **NT\$ 15,000 per page**
- Company name/logo on conference bags: **NT\$ 21,000 (with other logos) or NT\$ 99,000 (with your logo alone on 600 bags)**
- Company name/logo on badges: **NT\$ 42,000**
- Company name/logo on the entrance welcome sign: **NT\$ 30,000**
- 2014 Taiwanese BME Innovation Competition:
 1. Gold Medal Award named after the company+logo on the conference website: **NT\$ 50,000**
 2. Merit Award named after the company+ logo on the conference website: **NT\$30,000**
 3. Honorable Mention Award named after the company+logo on the conference website: **NT\$ 80,000**
 4. Best Creativity Award named after the company+logo on the conference website: **NT\$ 30,000**
 5. Best Potentiality Award named after the company+logo on the conference website: **NT\$ 30,000**

Advertisement Notice

Your advertisement information, such as images (>300 dpi), logos, contents, etc., should be e-mailed to Prof. Han-Sheng Chuang (oswaldchuang@mail.ncku.edu.tw) before **July 31, 2014**. Alternatively, you may burn the file in a CD and send it via post service.

Exhibit Booth

| | | |
|--------|--------------------|--|
| Booths | N=1 | N=2 or up |
| Rates | NT\$ 36,000 | NT\$ 36,000×N×0.95 (5% discount) |

- Booths : 25 (subject to change by the organizing committee)
- The priority is granted to the company renting more booths; otherwise, it will be determined by drawing at the exhibitor orientation.
- Full payment must be complete before **July 31, 2014**.
- Early Bird Discount: an extra 5% discount (To receive the discount, full payment must be made before **May 31, 2014**)

↕ Floor Plan

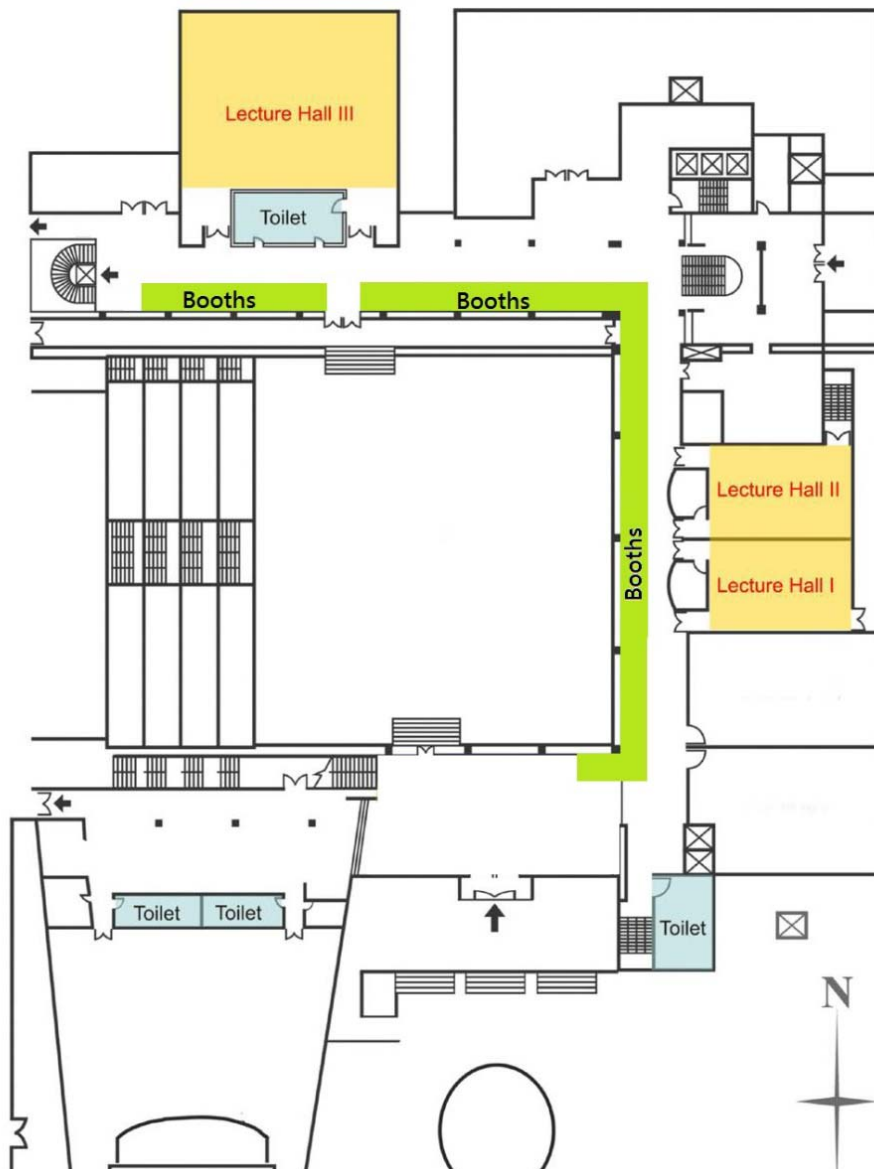

Exhibitor Information

● **Exhibit Location**

College of Medicine, National Cheng Kung University (Chien-Kuo Campus), Tainan, Taiwan.
1 University Road, Tainan 701, Taiwan

● **Set up & Dismantle**

| | | |
|------------|----------------------|---------------|
| Setup: | October 9 (Thursday) | 12:00 - 17:30 |
| Dismantle: | October 12 (Sunday) | 11:00 - 12:30 |

● **Exhibit Dates and Hours**

| | |
|-----------------------|---------------|
| October 9 (Thursday) | 15:00 - 17:30 |
| October 10 (Friday) | 08:30 - 17:30 |
| October 11 (Saturday) | 08:30 - 17:30 |
| October 12 (Sunday) | 08:30 - 12:00 |

● **Limitation of Liability**

The conference organizer shall not be liable to the exhibiting companies for any damage or loss of their properties/business resulting from fire, accident, insufficient participation or any other reasons in connection with the exhibition. All companies should consider purchasing insurance for their equipments and displays.

● **Booth layout**

The exhibiting area is divided into three locations: 13 booths are in the hallway right in front of Lecture Hall III; 7 booths are in the hallway right in front of the Lecture Hall I&II, and 5 booths are in the farther hallway (See the Floor Plan). Each booth (3 m x 2 m) includes one (1) table, two (2) chairs, one (1) sign board, a set of power outlet (110 V/5 A/60 Hz), three (3) showcase lamps, one (1) conference registration (excluding reception and banquet), two (2) exhibitor badges.

Cancellation Policy

Cancellation made before **Aug. 31, 2014** will be charged 50% of full payment for administration fees. No refund for cancellation made after **Aug.31, 2014**.

Contact Information

Prof. Han-Sheng Chuang (Sponsorship/Exhibit Coordinator)

Tel: +886-6-2757575 ext.63433

Mobile: +886-978035731

Fax: +886-6-2343270

Email: oswaldchuang@mail.ncku.edu.tw

GCBME 2014 & APCMBE 2014

October 9-12, 2014, Tainan, Taiwan

Please fill in this form using **CAPITAL** letters, and mail/fax it to:

GCBME 2014/APCMBE 2014 Secretariat,
Department of Biomedical Engineering,
National Cheng Kung University
1 University Road, Tainan 70101, Taiwan
TEL: +886-6-2760665
FAX: +886-6-2343270
E-mail: apcmbe9@conf.ncku.edu.tw

SPONSORSHIP REQUEST FORM

Company Name: _____

Contact Person: _____

Contact E-mail: _____

Company Address: _____

City: _____ Zip Code: _____ County: _____

Tel: _____ Fax: _____

SPONSORSHIP LEVELS

Please check the appropriate box:

- Platinum NT\$ 60,000
- Gold NT\$ 33,000
- Silver NT\$ 21,000

EXTRA SPONSORSHIPS

- Additional B&W pages NT\$15,000/page N=_____ NT\$15,000×N
- Company name/logo on conference bags (with other logos) NT\$51,000
- Company name/logo on conference bags (with your logo along on 600 bags) NT\$99,000
- Company name/logo on badge NT\$42,000
- Company name/logo on the entrance welcome sign NT\$30,000
- 2014 Taiwanese BME Innovation Competition : _____ NT\$_____
- Other : _____ NT\$_____

TOTAL AMOUNT (NT\$).....\$_____

PAYMENT METHOD (Credit Card Only)

The actual amount of charge is according to currency exchange made by the international Visa and MasterCard association.

- Master Card
- Visa Card
- JCB Card

PIN Number (the last 3 number on the back of the credit card)

Total amount (NT\$): _____

Credit card no: _____

Cardholder's name: _____ Expiration date: _____

Cardholder's address: _____

Cardholder's signature: _____ Date _____

(Same with the card's authorized signature)

(Please DO NOT fill in the following information)

Merchant ID: 6201604092 Approved Code: _____

GCBME 2014 & APCMBE 2014

October 9-12, 2014, Tainan, Taiwan

Please fill in this form using **CAPITAL** letters, and mail/fax it to:

GCBME 2014/APCMBE 2014 Secretariat,
Department of Biomedical Engineering,
National Cheng Kung University
1 University Road, Tainan 70101, Taiwan
TEL: +886-6-2760665
FAX: +886-6-2343270
E-mail: apcmbe9@conf.ncku.edu.tw

APPLICATION FOR EXHIBIT FORM

Company Name: _____
Contact Person: _____
Contact E-mail: _____
Company Address: _____
City: _____ Zip Code: _____ County: _____
Tel: _____ Fax: _____

Exhibit Booth

Please check the appropriate box:

- | | |
|--|--------------|
| <input type="checkbox"/> One (1) booth | NT\$ 36,000 |
| <input type="checkbox"/> Two (2) booths | NT\$ 68,400 |
| <input type="checkbox"/> Three (3) booths | NT\$ 102,600 |
| <input type="checkbox"/> Four (4) booths | NT\$ 136,800 |
| <input type="checkbox"/> Early Bird Discount (extra 5% discount) | |

TOTAL AMOUNT (NT\$).....\$ _____

PAYMENT METHOD (Credit Card Only)

The actual amount of charge is according to currency exchange made by the international Visa and MasterCard association.

Master Card Visa Card JCB Card

PIN Number (the last 3 number on the back of the credit card)

Total amount (NT\$): _____

Credit card no: _____

Cardholder's name: _____ Expiration date: _____

Cardholder's address: _____

Cardholder's signature: _____ Date _____

(Same with the card's authorized signature)

(Please DO NOT fill in the following information)

Merchant ID: 6201604092 Approved Code: _____